

INSTALACIÓN

1 COMPONENTES

pg2

2 INSTALACIÓN HORIZONTAL

pg3

- **2.1** Mecanización de los costados
- **2.2** Instalación Perfil Gola Superior en módulo con tapa
- **2.3** Instalación Perfil Gola Superior en módulo con perfil refuerzo
- **2.4** Medidas para la colocación del clip para Perfil Gola Superior
- **2.5** Instalación Perfil Gola Intermedio
- **2.6** Medidas para la colocación del clip para Perfil Gola Intermedio

3 ACCESORIOS GOLA PARA PERFIL TRADICIONAL SUPERIOR

pg8

4 ACCESORIOS PARA PERFIL GOLA TRADICIONAL INTERMEDIO

pg9

5 INSTALACIÓN VERTICAL CON TORNILLO VISTO

pg10

6 INSTALACIÓN VERTICAL MIXTO TORNILLO VISTO Y NO VISTO

pg11

7 INSTALACIÓN VERTICAL SIN TORNILLO VISTO

pg12

1 COMPONENTES

Perfil superior-lateral

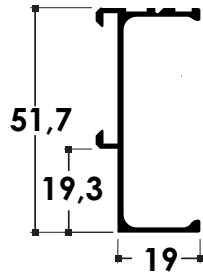
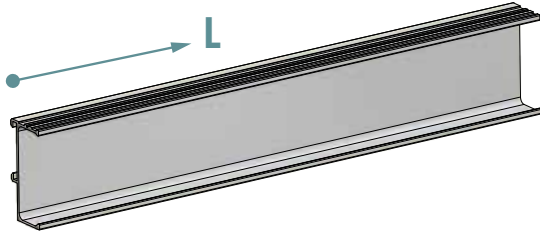

L₁: 2950 mm

L₂: 2670 mm (105 1/8 in)

Perfil intermedio Vertical-Horizontal

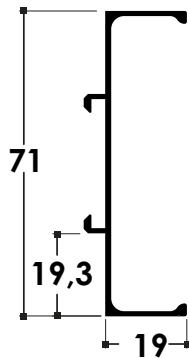
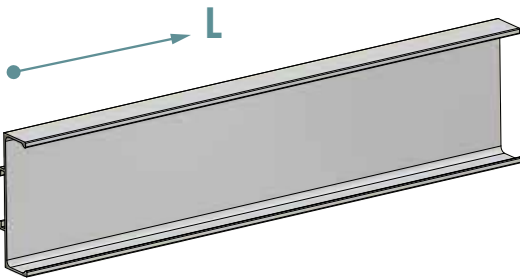

L₁: 2950 mm

L₂: 2670 mm (105 1/8 in)

Clip Gola

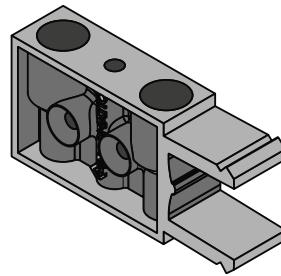
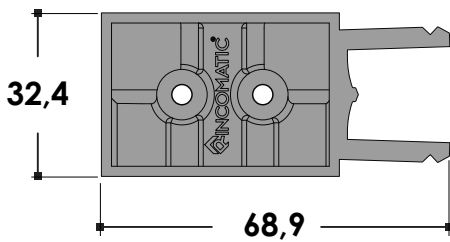

Suplemento 1mm para costado de 18mm

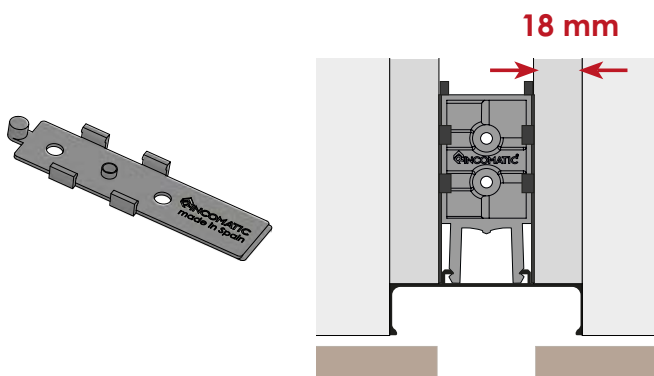

Suplemento 3mm para costado de 16mm

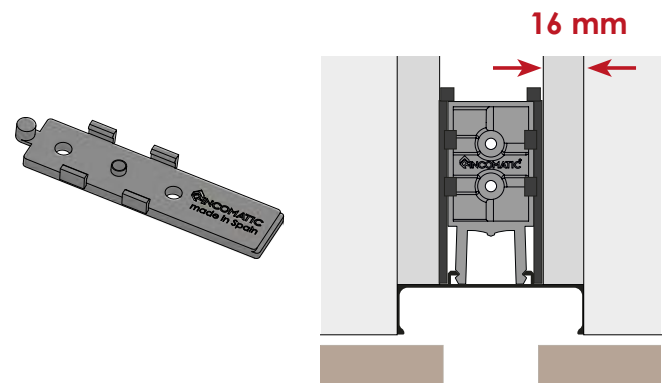

2 INSTALACIÓN HORIZONTAL

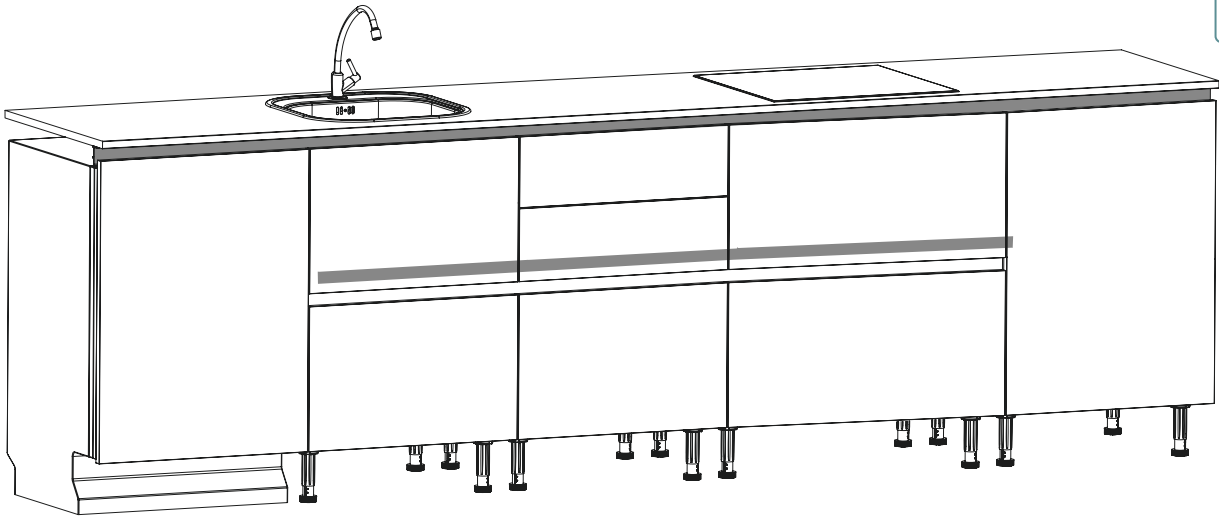
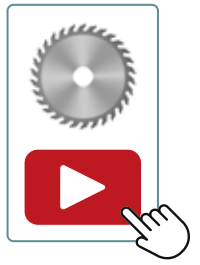

■ 2.1 MECANIZACIÓN DE LOS COSTADOS

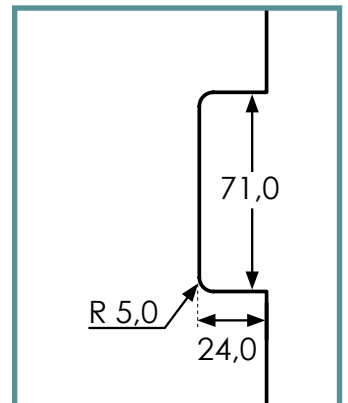
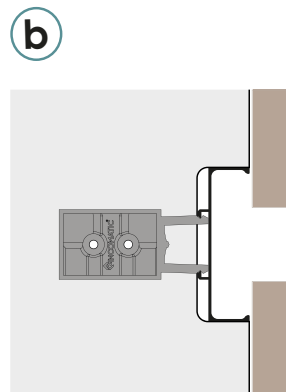
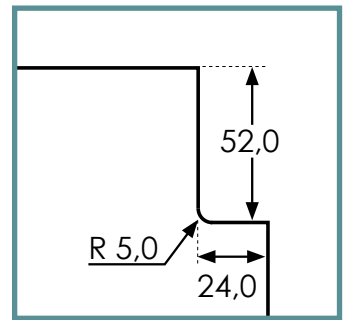
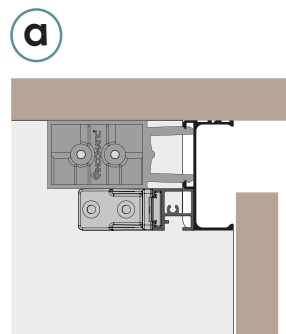
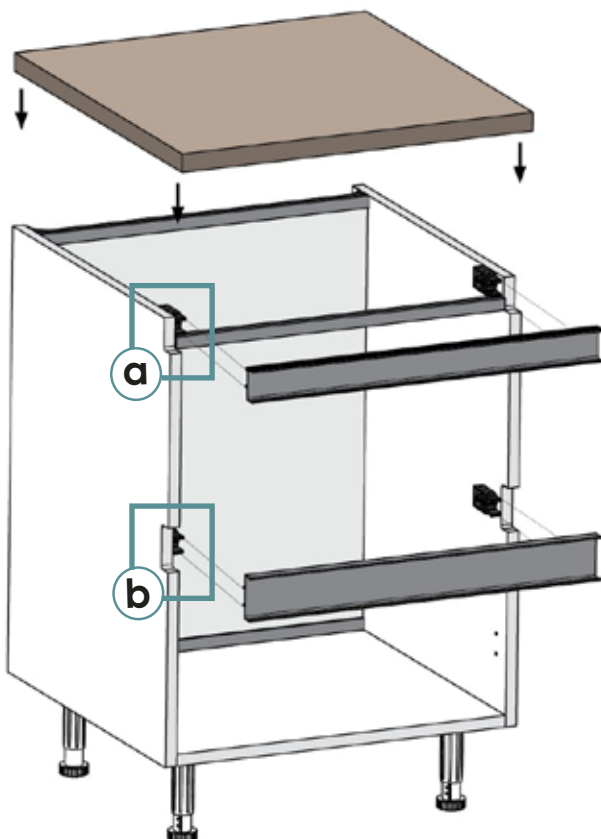

■ 2.2 INSTALACIÓN PERFIL GOLA SUPERIOR *En módulo con tapa*

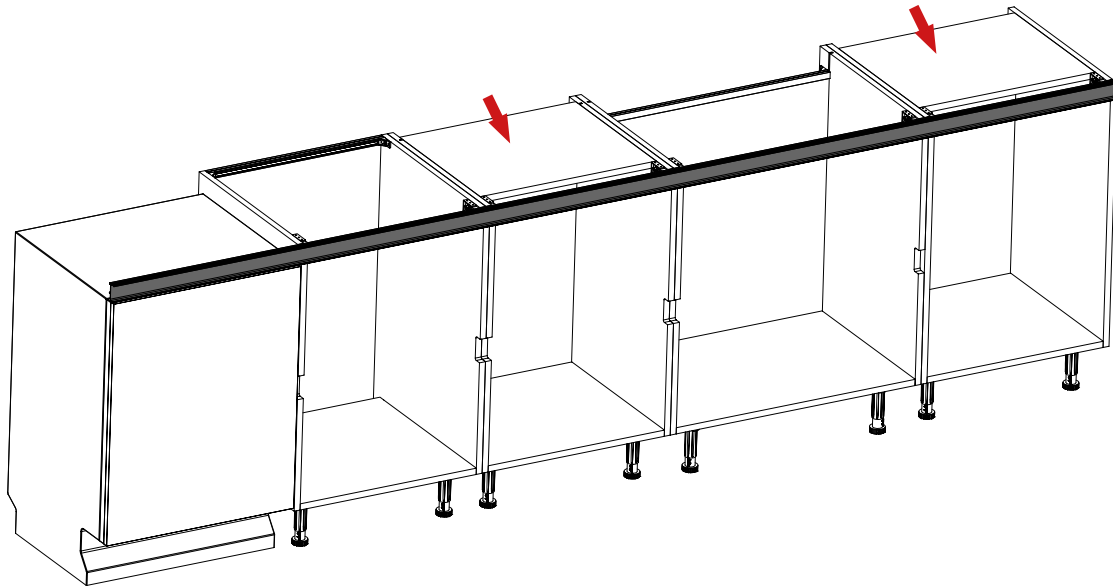
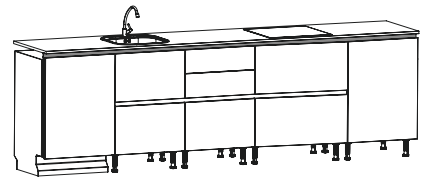

La tapa del módulo debe ser retranqueada al menos 92 mm

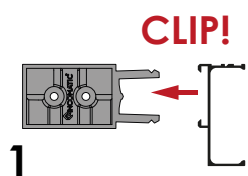

1
Clipar

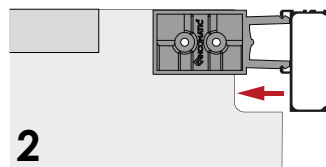

2
Colocar el perfil

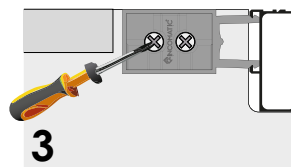

3
Atornillar el clip al costado

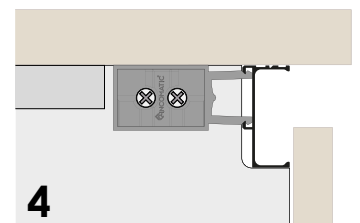

4
Colocar la encimera

■ 2.3 INSTALACIÓN PERFIL GOLA SUPERIOR *En módulo con perfil refuerzo*

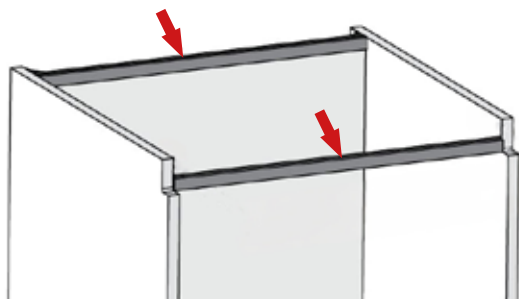
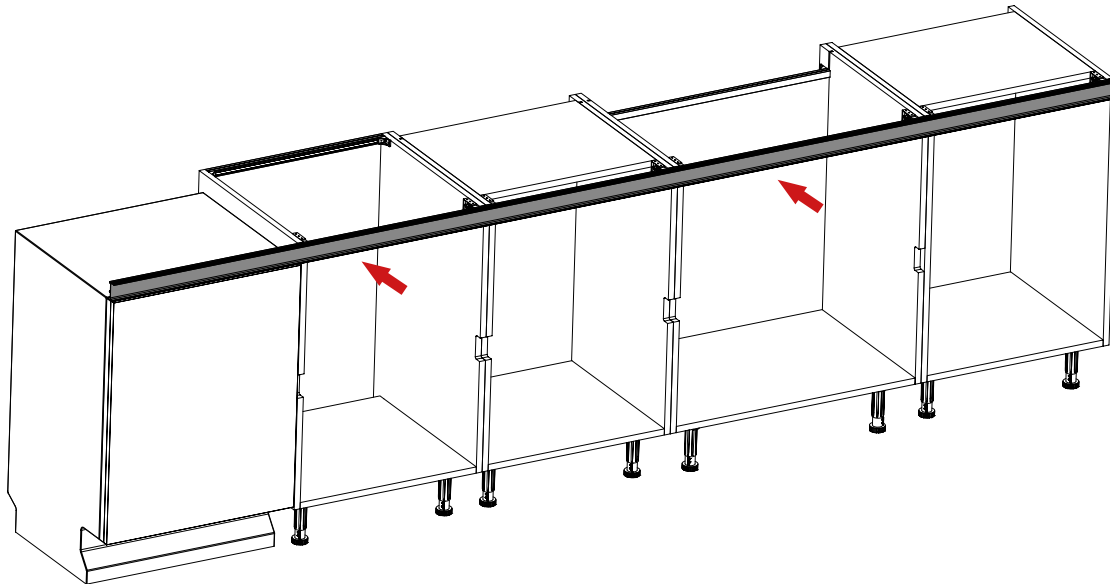
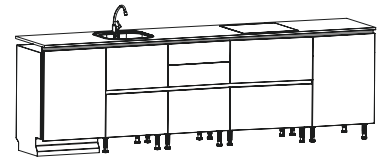

Perfil Refuerzo

Su instalación es recomendable en muebles fregaderos, vitro, inducción



[+ info](#)

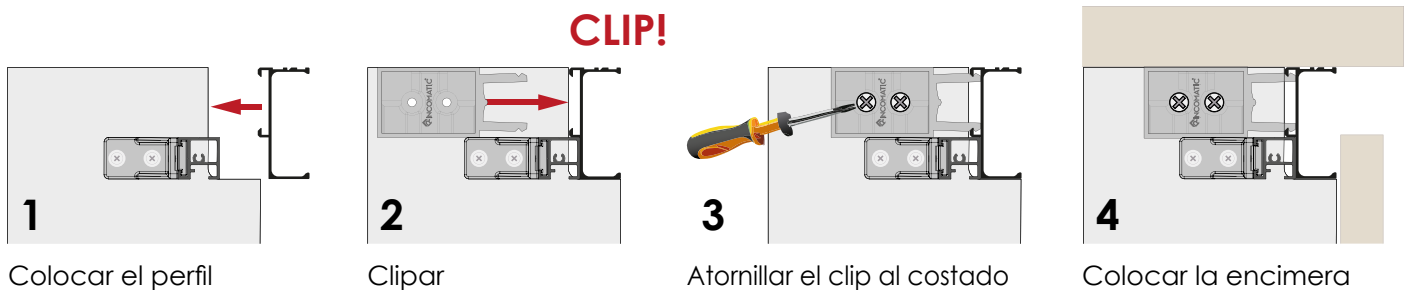

2.4 MEDIDAS PARA LA COLOCACIÓN DEL CLIP PARA PERFIL GOLA SUPERIOR

Perfil Enrasado a línea frente

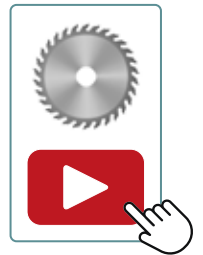
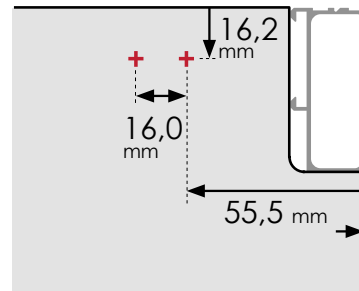
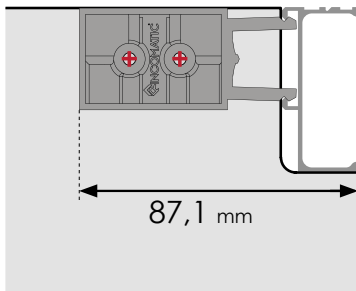

Perfil Desenrasado

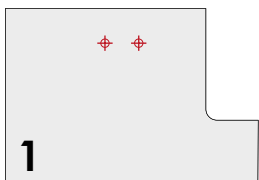
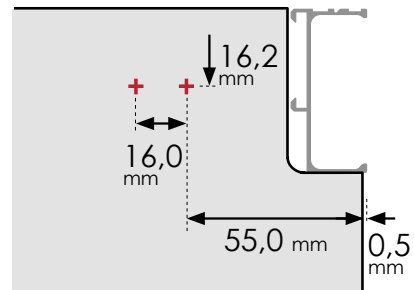
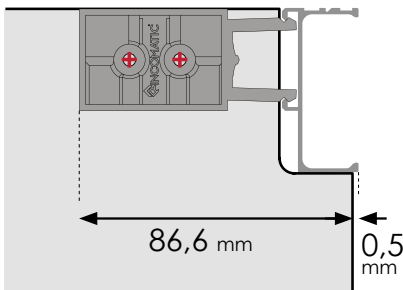

1
Marcar la posición de los tornillos

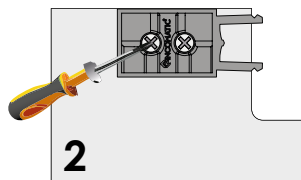

2
Atornillar el clip al costado

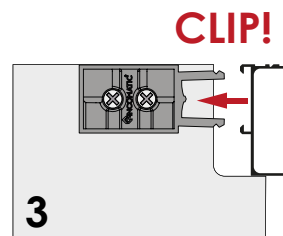

3
Clipar

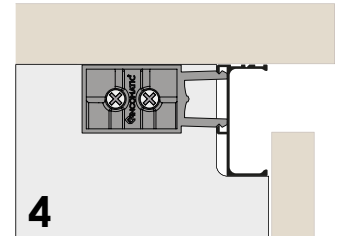

4
Colocar la encimera



2.5 INSTALACIÓN PERFIL GOLA INTERMEDIO

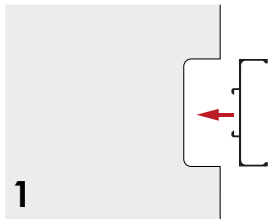

1 Colocar el perfil

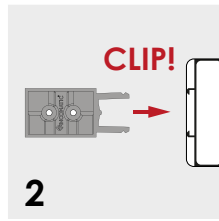

2 Clipar

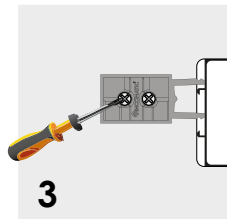

3 Atornillar el clip al costado

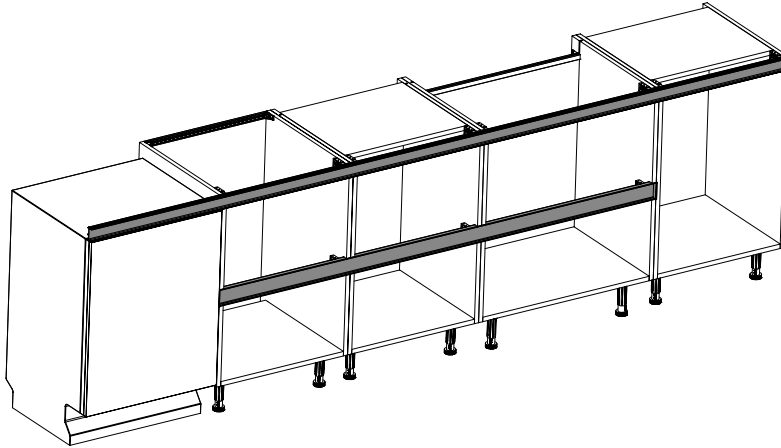

2.6 MEDIDAS PARA LA COLOCACIÓN DEL CLIP PARA PERFIL GOLA INTERMEDIO

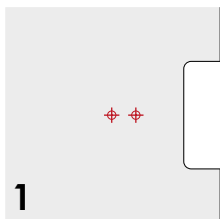
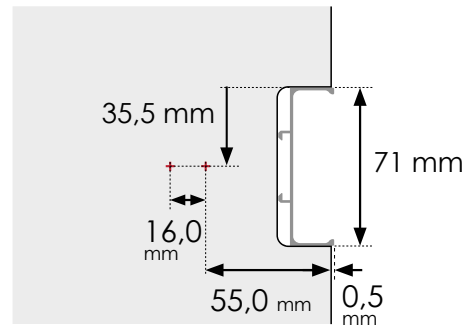
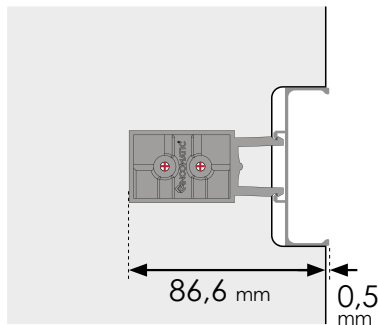

1 Marcar la posición de los tornillos

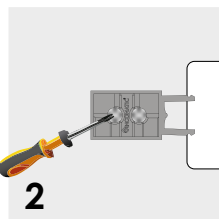

2 Atornillar el clip al costado

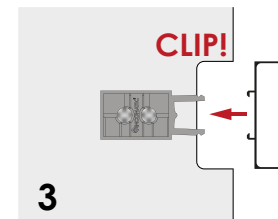

3 Clipar

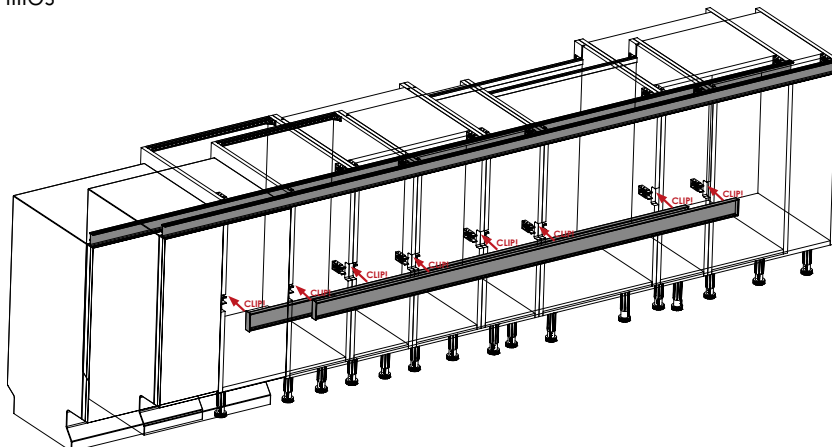

3 ACCESORIOS GOLA PARA PERFIL TRADICIONAL SUPERIOR

Unión interior 90°

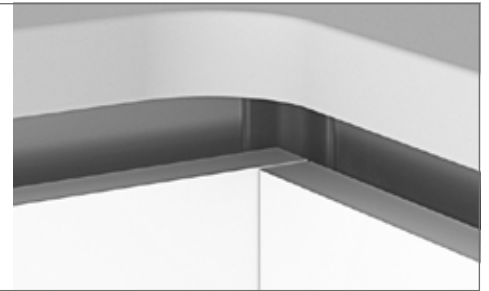
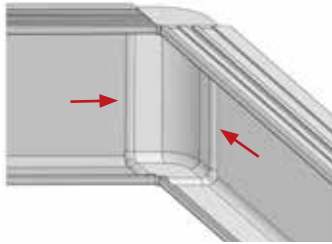
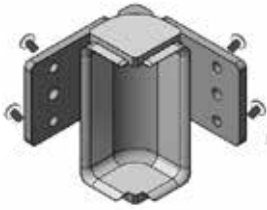

Unión exterior 90°

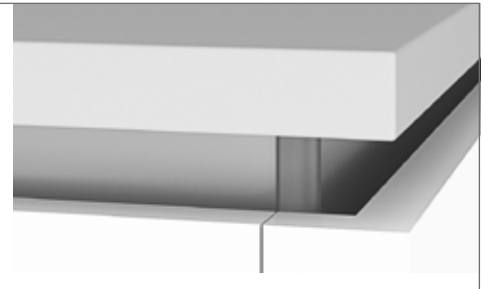
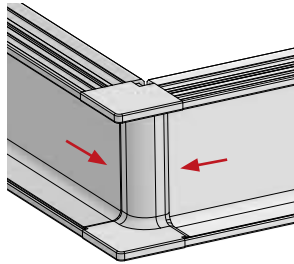
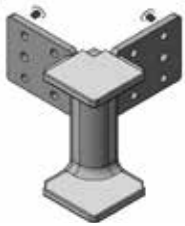

Unión chaflán 90°

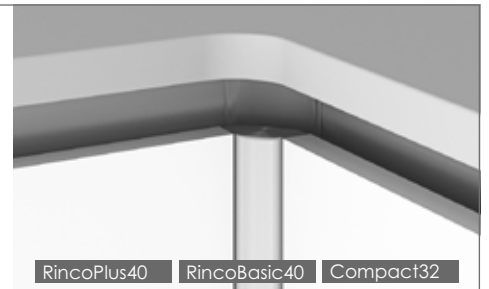
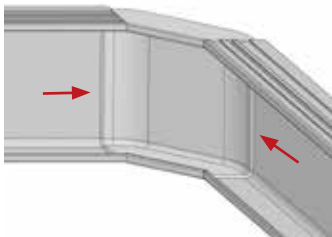

RincoPlus40 RincoBasic40 Compact32

Escuadra universal de fijación

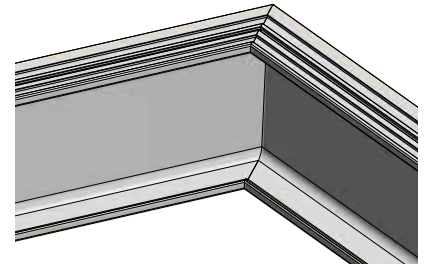
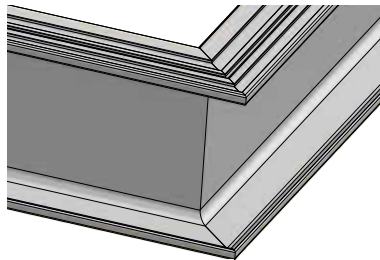
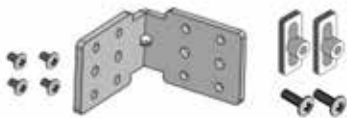

Pletina de unión

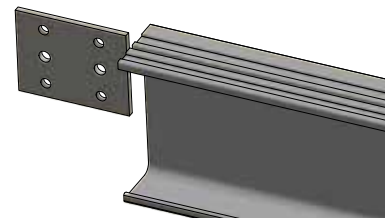
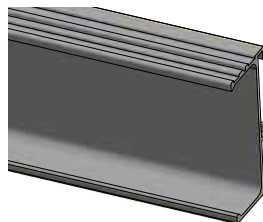
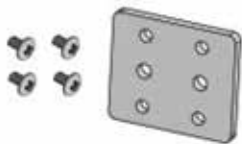

Pareja de terminales superior exterior

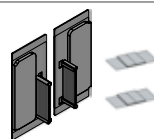

Pareja de terminales superior exterior PINTADO

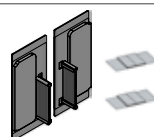

4 ACCESORIOS PARA PERFIL GOLA TRADICIONAL INTERMEDIO

Pareja terminales intermedio exterior para lavavajillas

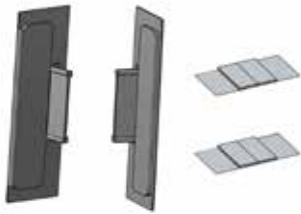

Terminal intermedio exterior para lavavajillas PINTADO

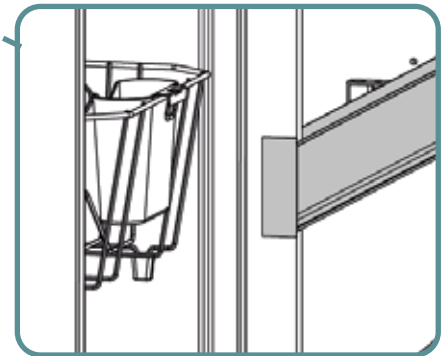
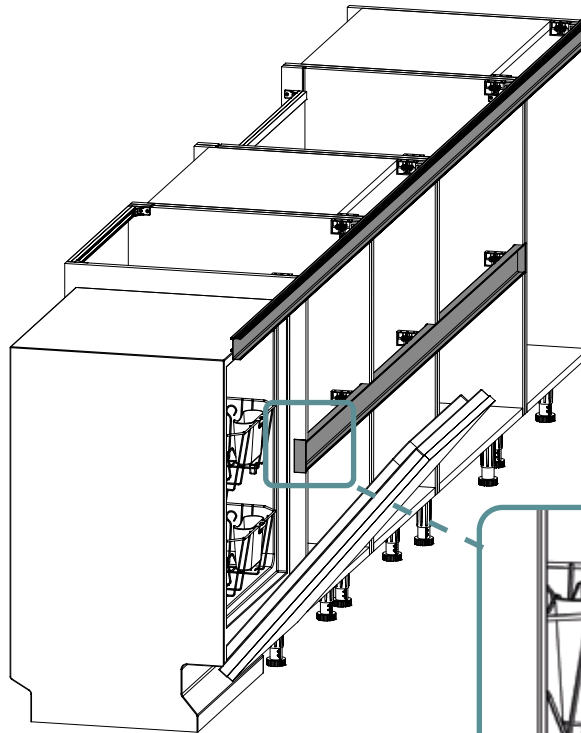

Pareja terminales intermedio (contra mueble)

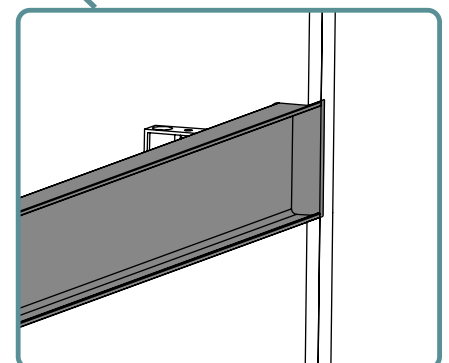
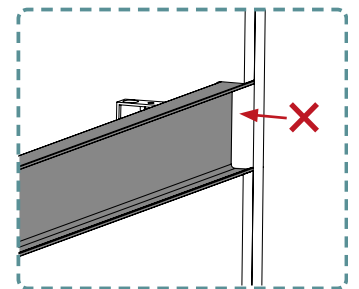
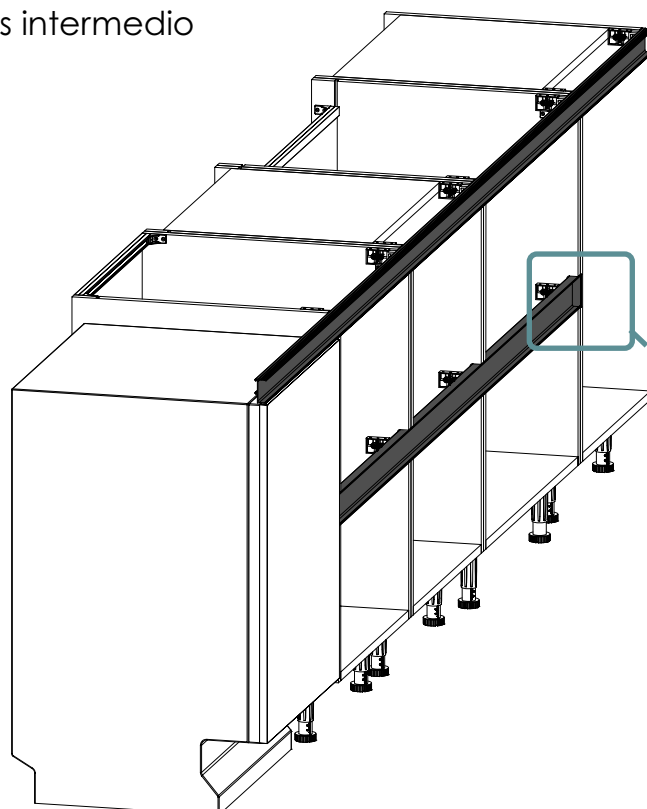
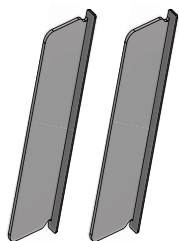

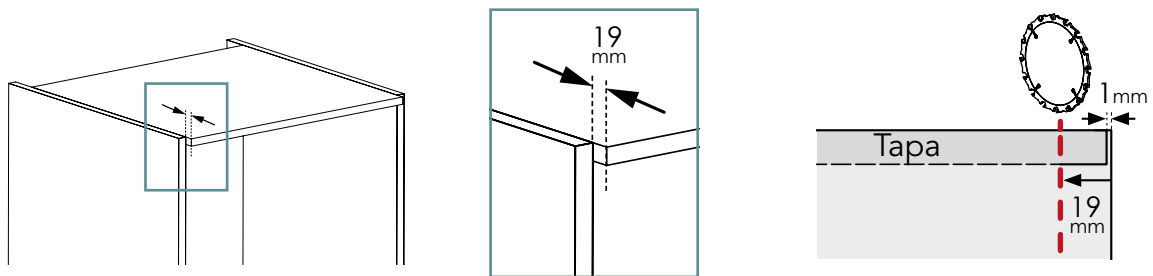
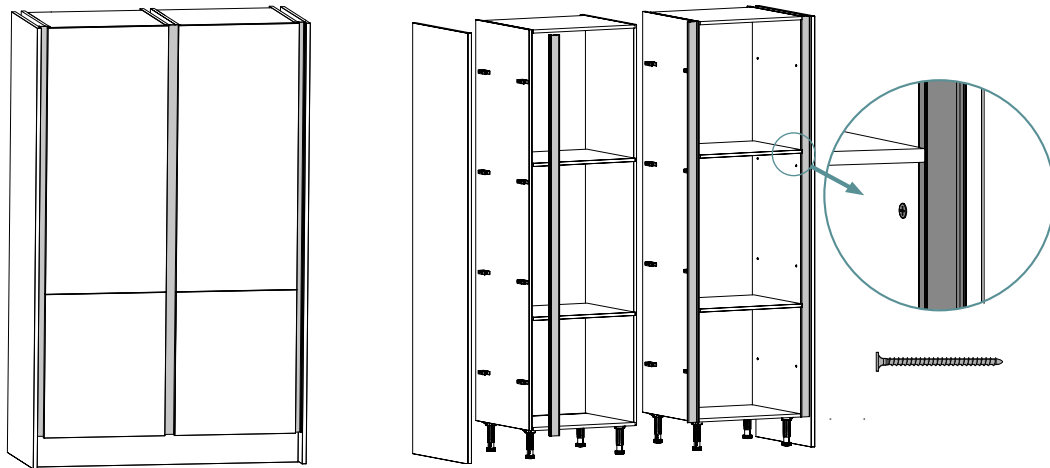

5 INSTALACIÓN VERTICAL CON TORNILLO VISTO

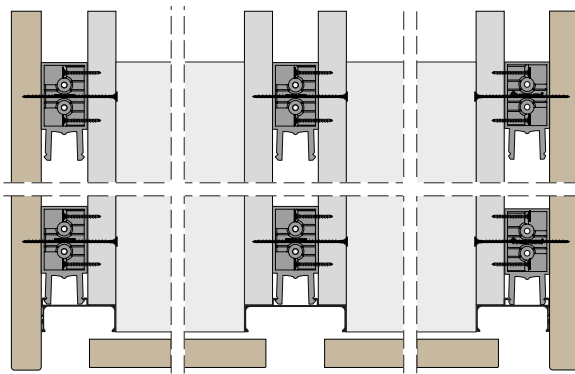
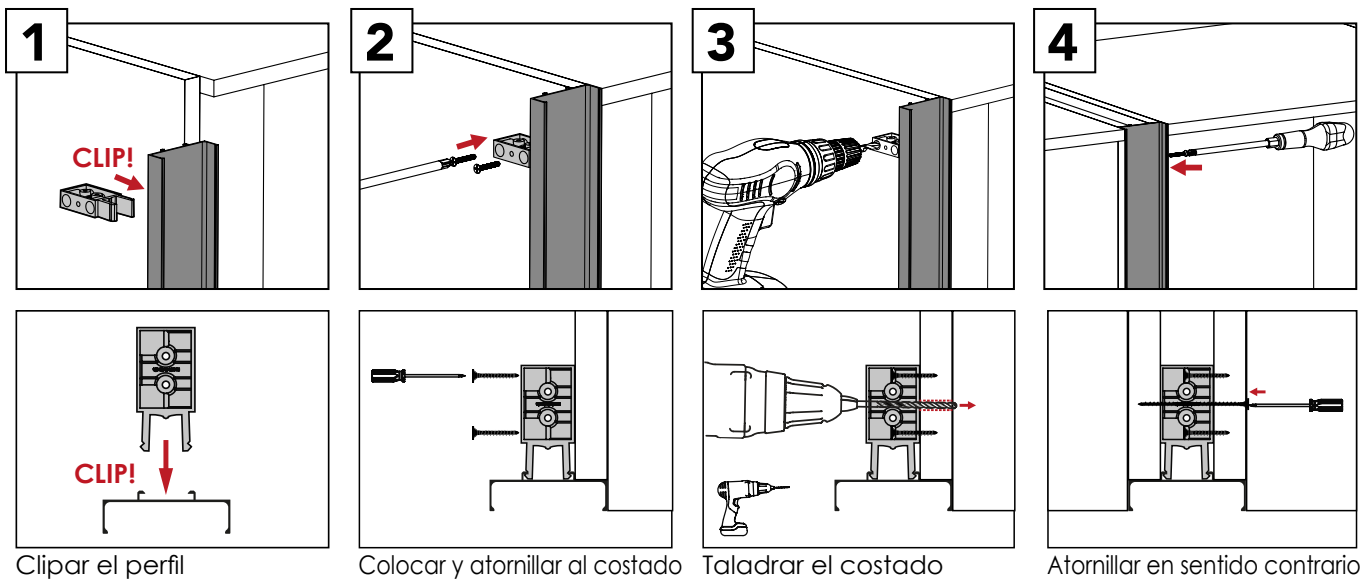

el costado debe ser cortado 19 mm



⚠ Elementos requeridos (no incluidos)	
	4 x 30
	4,5 x 65
	Broca de 4,5

6 INSTALACIÓN VERTICAL MIXTO TORNILLO VISTO Y NO VISTO

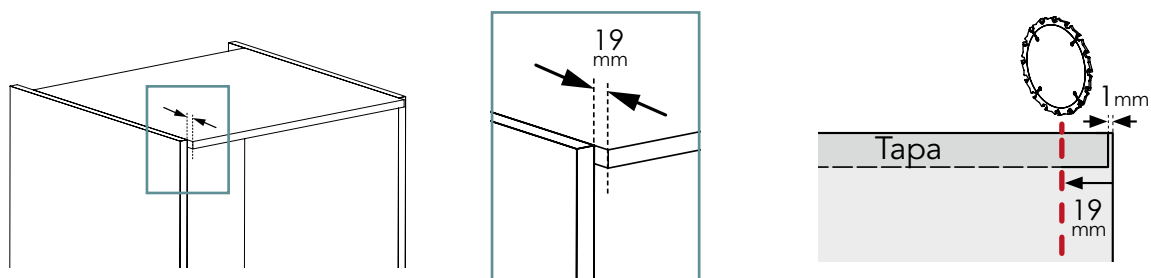
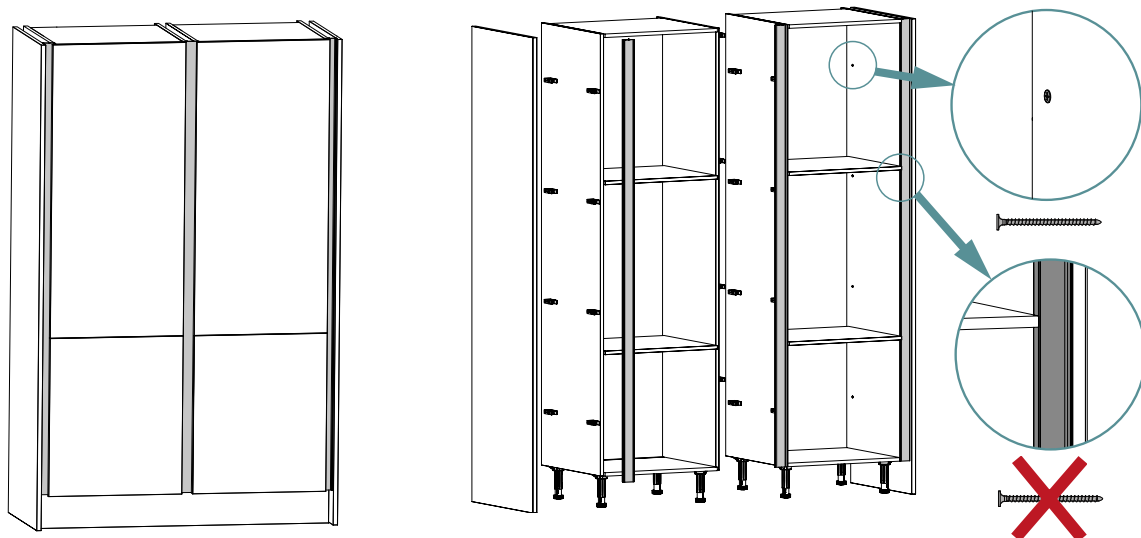

el costado debe ser cortado 19 mm

Parte delantera

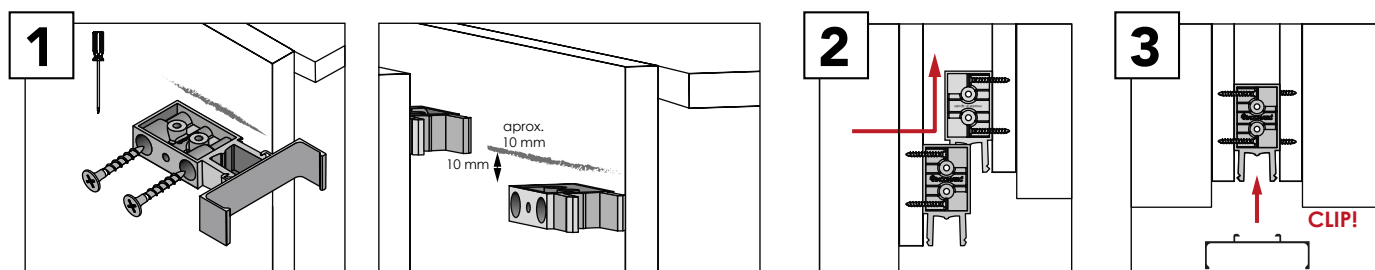

1 Atornillar los clips a los costados usando un trocizo de perfil para posicionarlo en su sitio. Los clips de ambos módulos deben tener una separación en altura de 10 mm aprox

2 Juntar ambos módulos

3 Clipar el perfil, así ambos módulos quedarán unidos

Parte trasera

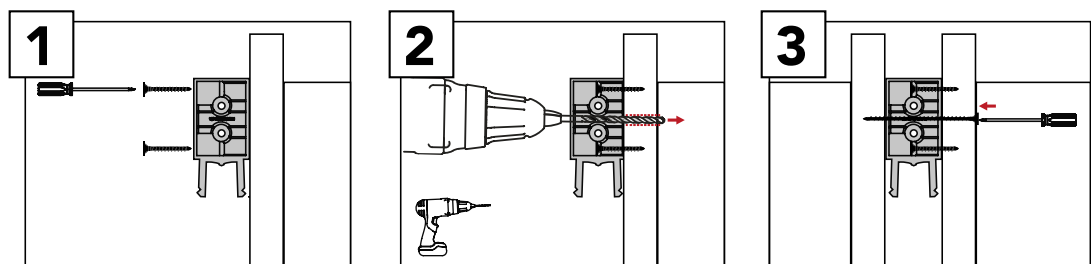

1 Atornillar al costado

2 Taladrar el costado

3 Atornillar en sentido contrario

7 INSTALACIÓN VERTICAL SIN TORNILLO VISTO

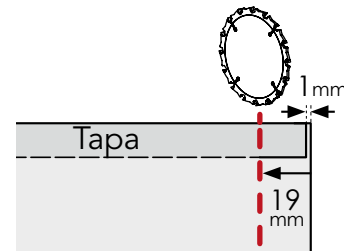
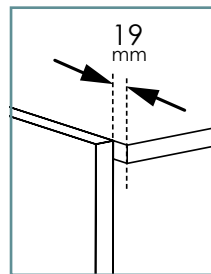
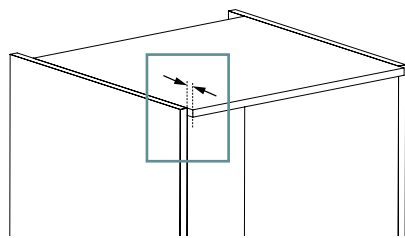
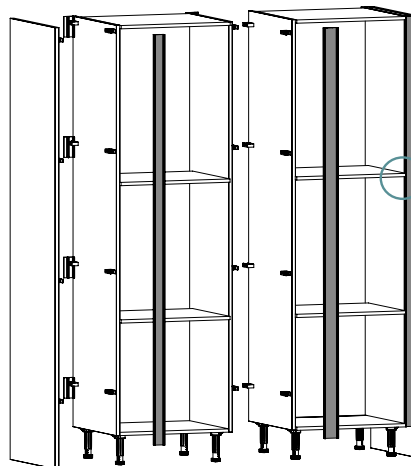
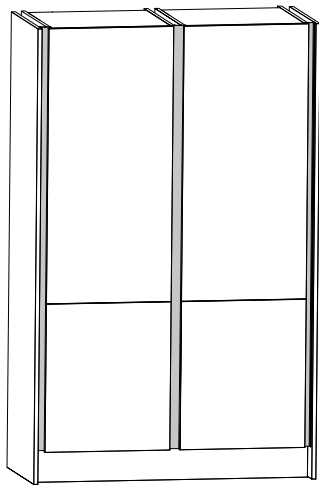
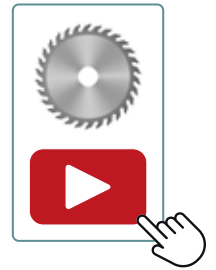

el costado debe ser cortado 19 mm

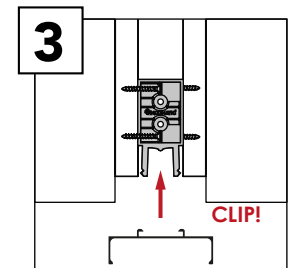
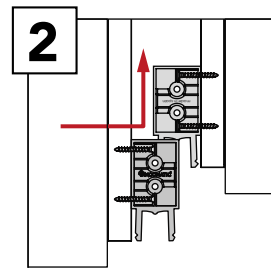
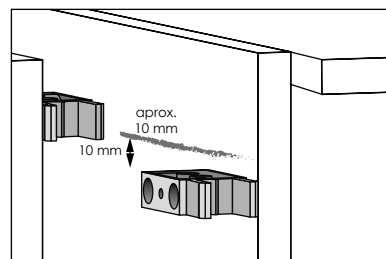
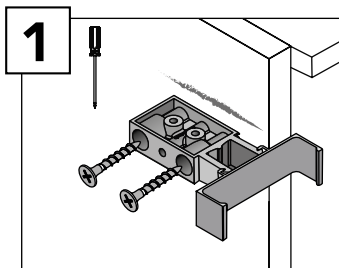

Atornillar los clips a los costados usando un trocillo de perfil para posicionarlo en su sitio. Los clips de ambos módulos deben tener una separación en altura de 10 mm aprox

Juntar ambos módulos

Clipar el perfil, así ambos módulos quedarán unidos

